

SITUACIJA URBANISTIČKE PARCELE BR.16 SA DUP-α"ULCINJSKO POLJE"

Urb. parcela br.16=522.00m² u zoni B podzona 5
 Katastarska parcela br. 30/389=522.00 m² l.n 558 K.o Ulcinjsko Polje
 svojina Kovači Ali

R=1:500

Kordinate tačke urbanističke parcele

39	6603220.06	4642682.56
40	6603191.67	4642701.28
41	6603183.10	4642688.55
42	6603195.21	4642680.56
43	6603211.49	4642669.82

Kordinate tačke regulacione linije

39	6603220.06	4642682.56
40	6603191.67	4642701.28
41	6603183.10	4642688.55
43	6603211.49	4642669.82

Kordinate tačke gradjevske linije

A	6603187.28	4642685.79
B	6603195.84	4642698.53

— Urb. parcela po DUP-u

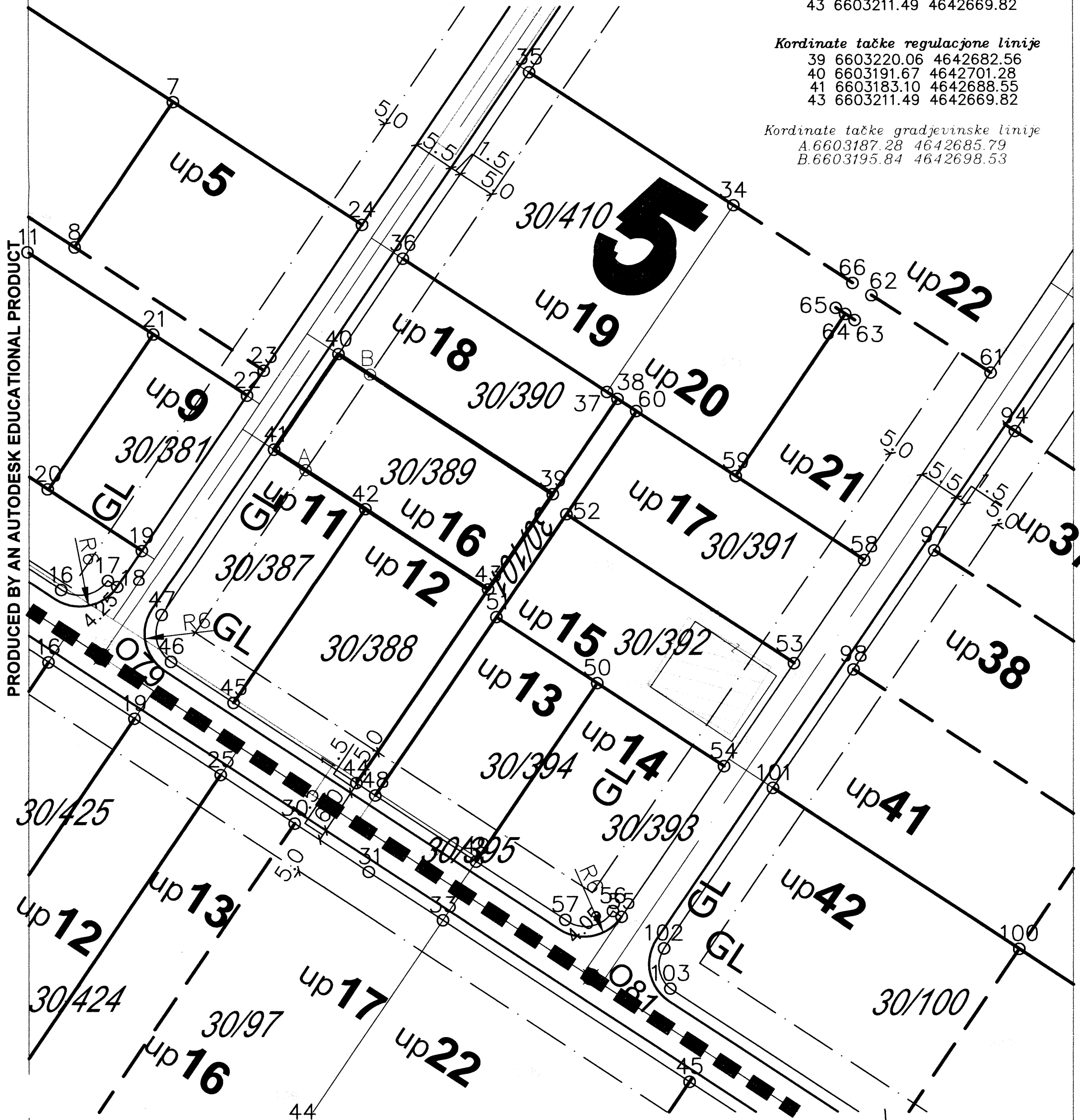

PRODUCED BY AN AUTODESK EDUCATIONAL PRODUCT

PRODUCED BY AN AUTODESK EDUCATIONAL PRODUCT

Pjeter Dobreci geom
 17.80

Ulcinj/2014

v.d. Sekretar,
 arh. Valon Buzuku dip.ing

